

Banner Estrella Medical Center

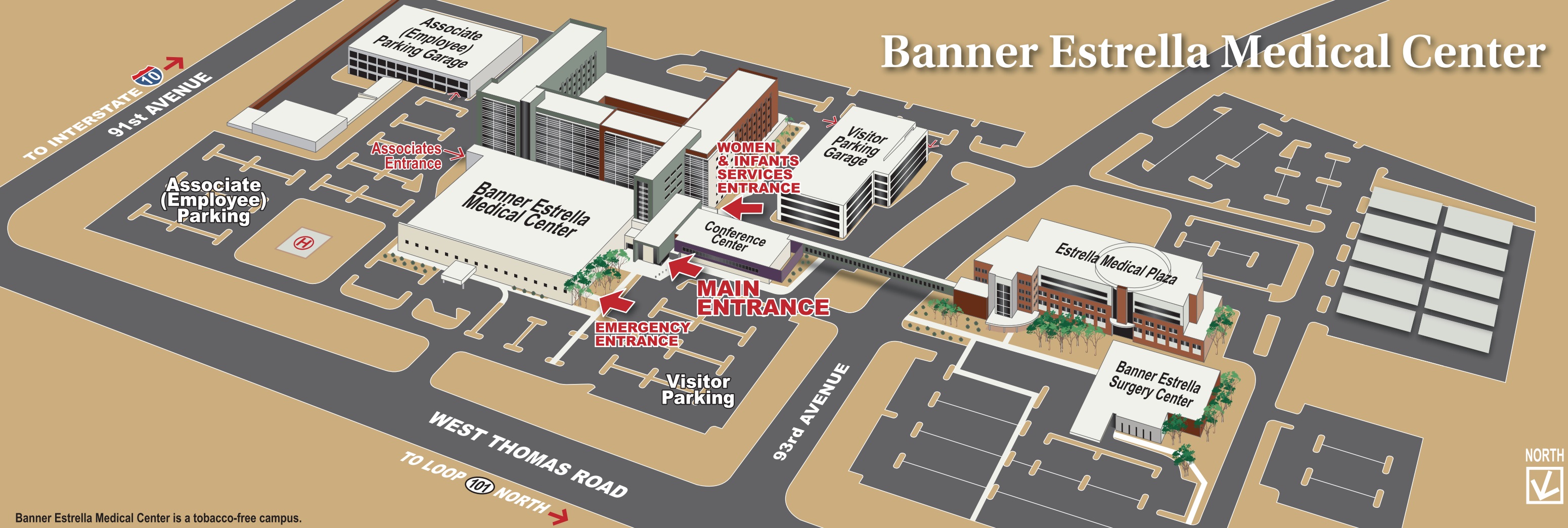

Banner Estrella Medical Center is a tobacco-free campus.

Health Care for a Growing Community

Banner Estrella Medical Center offers all private rooms in an environment that incorporates advanced technology, inclusive family care practices and a healing environment where soothing colors, natural light and comfortable furnishings are used extensively. The 50-acre medical campus offers a full array of medical services, including:

- Cancer Care
- Bariatric Surgery
- Emergency Services
- General Surgery
- Heart Care Services
- Maternity Services
- Medical Imaging
- Orthopedics
- Rehabilitation
- Women & Infants Services

Visiting Hours

Created as a holistic healing environment, Banner Estrella stresses the importance of family and friends in the process of healing so there are no specific visiting hours. Please check with the floor nurse for more information and restrictions based on the patient's care needs.

Visitor Parking

Visitor parking is available on three sides of the hospital campus. Visitors can park on the southwest corner of the facility to access the lobby area and Women and Infants Services. Visitors can also access the lobby from the northwest parking lot. Visitors to the Emergency Department can park on the west side of the campus, near the Emergency Department entrance.

Escorts between visitor parking and the hospital are available through hospital Security. For an escort, please call (602) 747-4400 or 1-4400 from inside Banner Estrella 24 hours a day.

ATM

Banner Estrella offers one automatic teller machine, located in an alcove off the main corridor on the first floor of the Diagnostic & Treatment building.

Gift Shop

The Banner Estrella Gift Shop is located just east of the front lobby along the north side of the hospital's main corridor. The Banner Family Pharmacy is located within the Gift Shop. Visitors can purchase books, magazines, personal items, gifts and flowers.

Gift Shop hours are as follows:
 Monday through Friday 10 a.m. to 8 p.m.
 Saturday 10 a.m. to 6 p.m.
 Sunday 10 a.m. to 5 p.m.

Banner Estrella Café

The Banner Estrella Café is located on the first floor of the Diagnostic & Treatment building off the hospital's main corridor. Banner Estrella Café offers a wide selection of entrees and quick snacks for patients, family members and associates.

Hours are:
 Breakfast 6 to 10 a.m.
 Lunch 11 a.m. to 2 p.m.
 Dinner 4 to 7 p.m.
 Late Night 8 p.m. to 1:30 a.m.

Patients can order room service from the Banner Estrella Café for guests with a valid credit or debit card.

Location Map

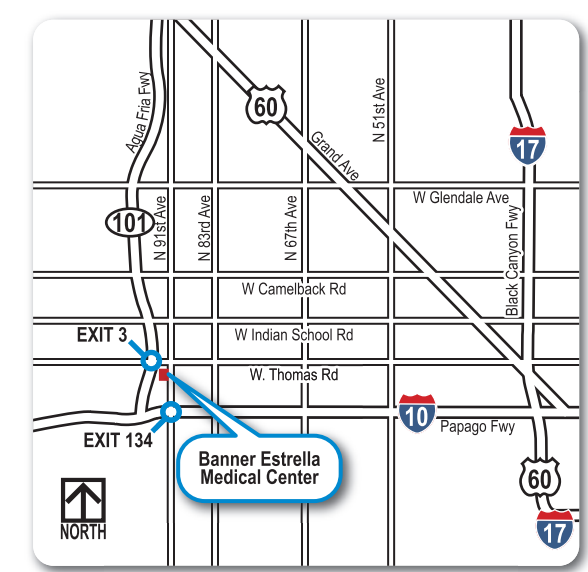

Banner Estrella Medical Center
 9201 West Thomas Rd
 Phoenix, Arizona 85037

(623) 327-4000
www.BannerHealth.com/Estrella



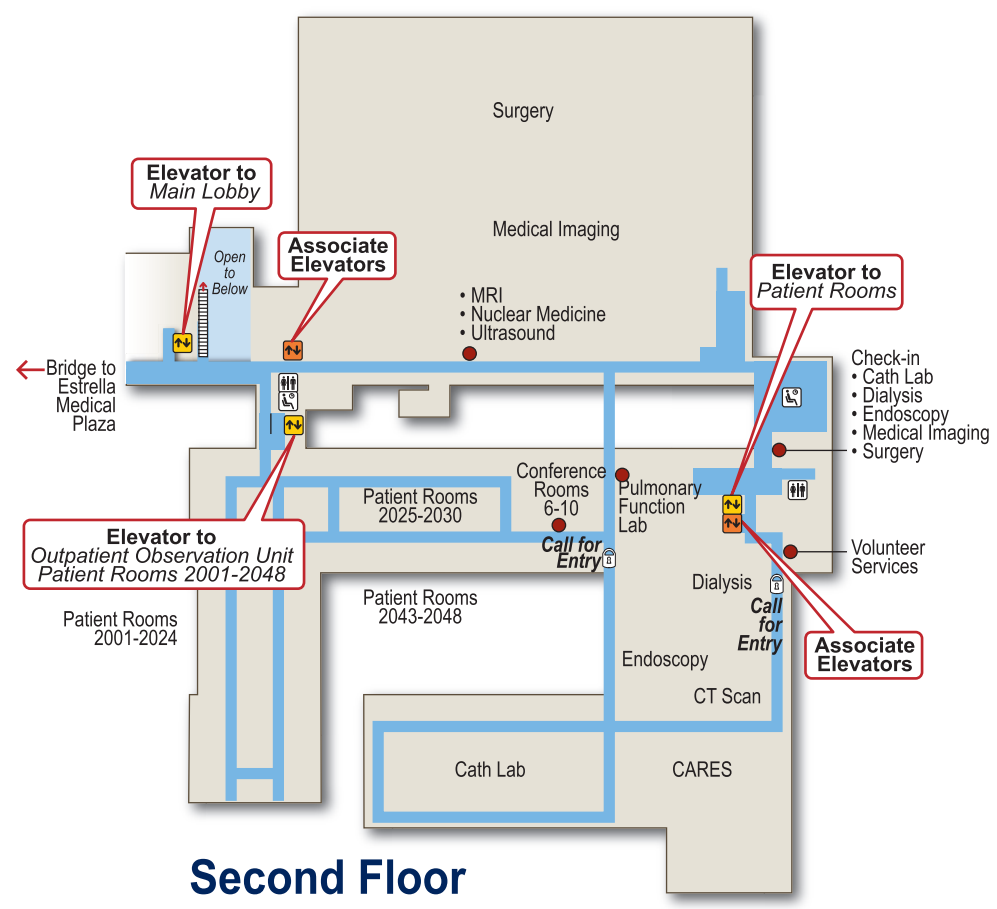
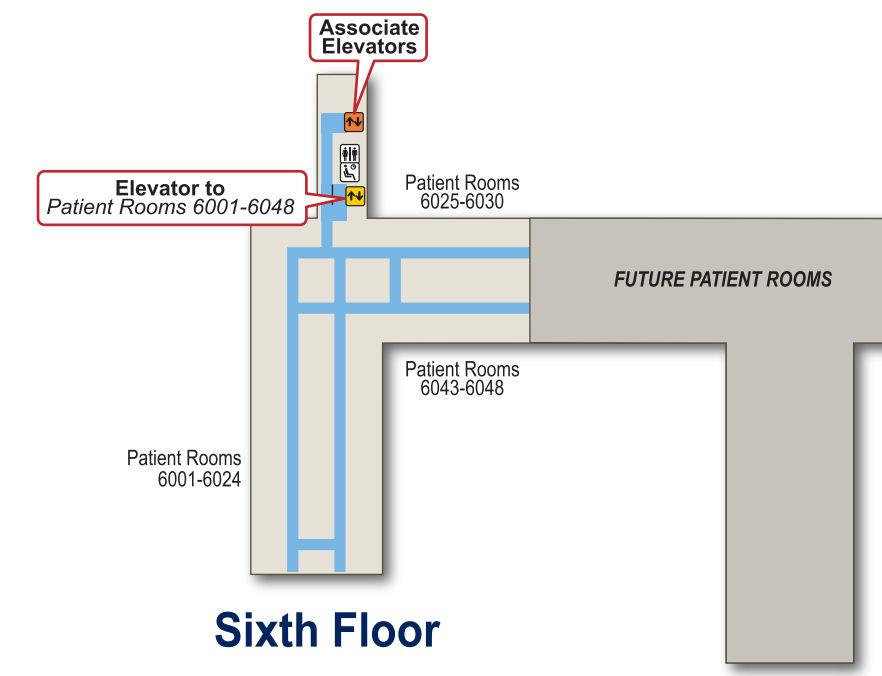
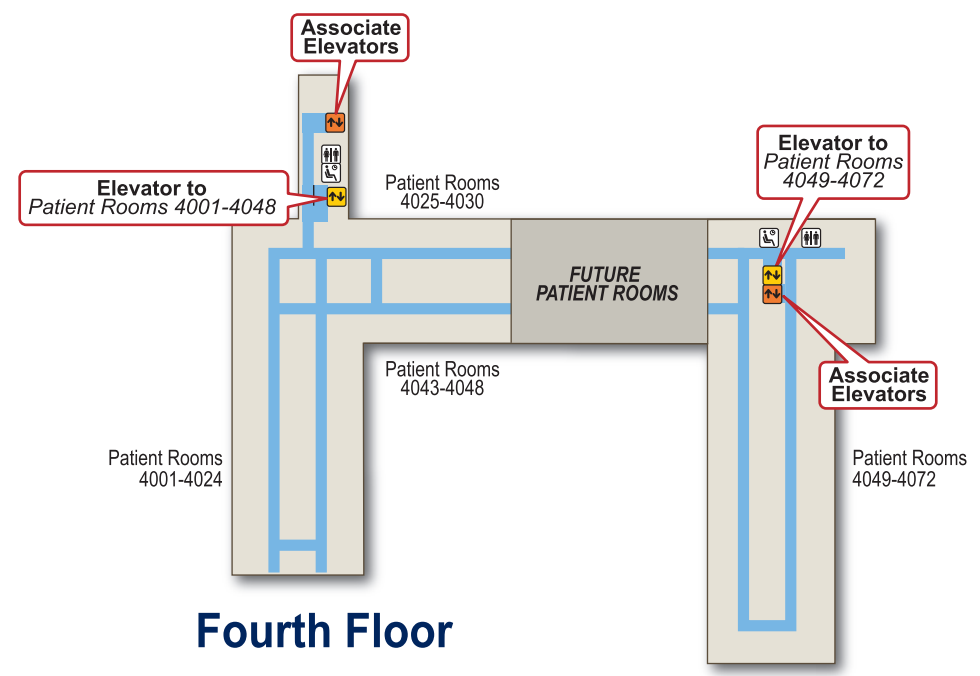
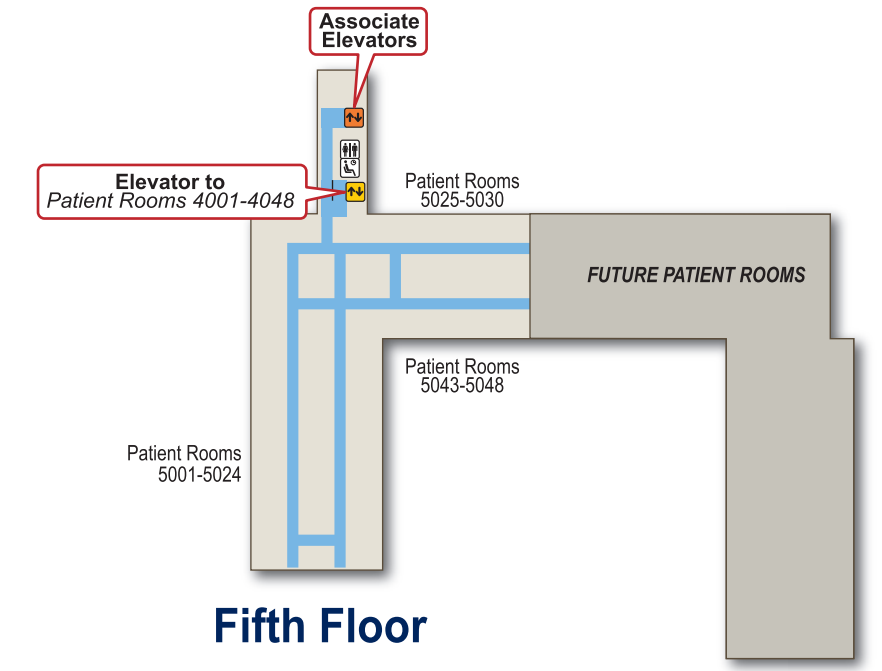
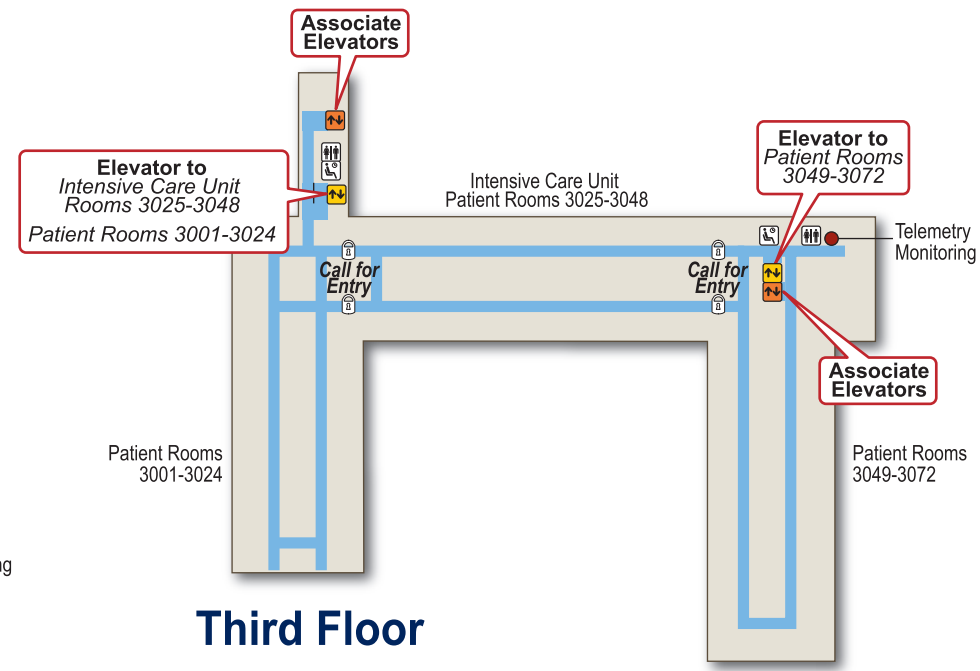
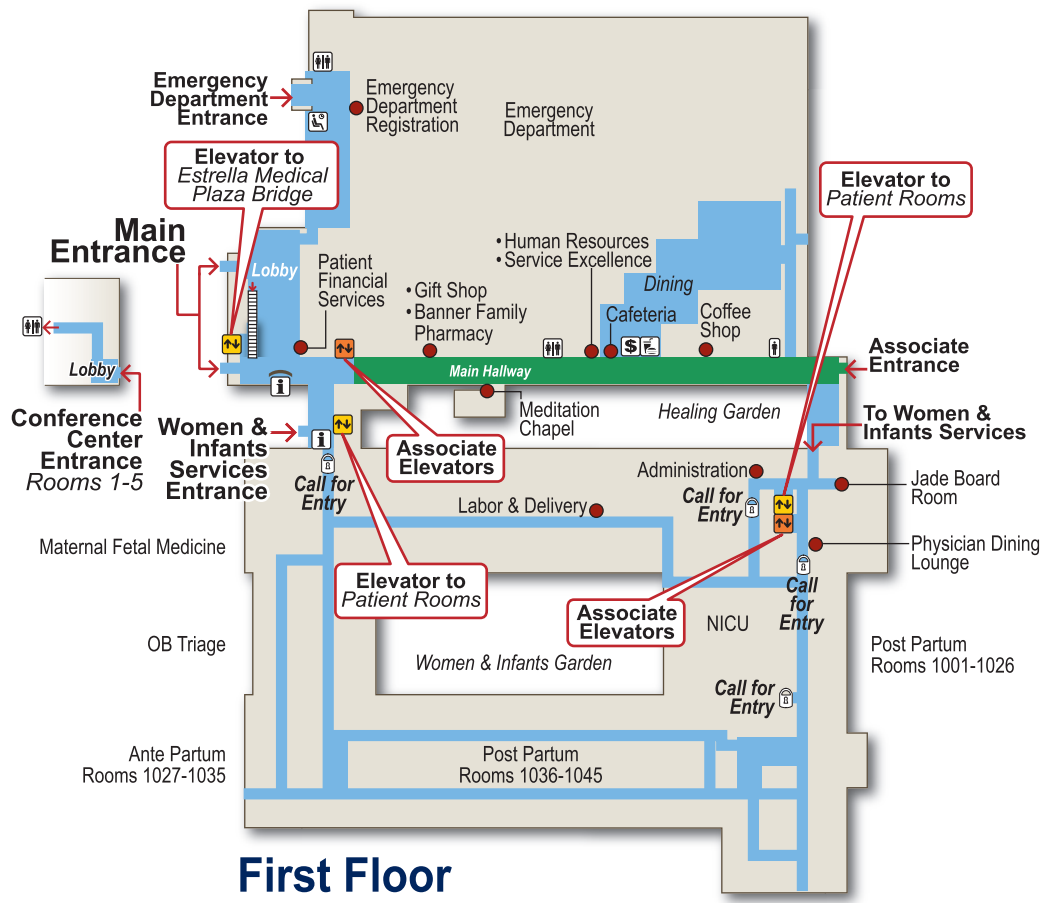

Department	Floor	Department	Floor	Department	Floor
Administration	1	Intensive Care Unit	3	Patient Rooms 1001-1045	1
Ante Partum	1	Intensive Care Unit Patient Rooms 3025-3048	3	Patient Rooms 2001-2048	2
Banner Family Pharmacy	1	Jade Board Room	1	Patient Rooms 3001-3072	3
Cafeteria	1	Labor & Delivery	1	Patient Rooms 4001-4072	4
CARES	2	Maternal Fetal Medicine	1	Patient Rooms 5001-5048	5
Cath Lab	2	Medical Imaging	2	Patient Rooms 6001-6048	6
CT Scan	2	Meditation Chapel	1	Patient Rooms 6025-6030	6
Coffee Shop	1	MRI	2	Patient Rooms 6043-6048	6
Conference Rooms 6-10	2	Neonatal Intensive Care Unit	2	FUTURE PATIENT ROOMS	6
Dialysis	2	Nuclear Medicine	2		
Emergency Department Registration	1	OB Triage	1		
Endoscopy	2	Outpatient Observation Unit	2		
Gift Shop	1	Outpatient Observation Unit Patient Rooms 2001-2048	2		
Human Resources	1	Patient Financial Services	1		

Map Key

- Information
- Elevator
- Associate Elevator
- Restrooms
- Waiting
- Vending
- ATM
- Restricted Access